

TYCROC SHOWER BASE AND LINEAR DRAINAGE



Tycroc shower base set consists of a shower base and a linear drainage system . Both components are coordinated with each other and form one unit.

For the installation of Tycroc shower base building, the surface must be dry, inflexible and stable. Also, it must be clean of dirt, oil and other lubricants and not frozen.

CUTTING AND STORAGE

It is easy to cut the Tycroc shower base with electrical circular saw, keyhole saw, handsaw or cut-off blades. For drilling of holes, rock, metal and wood drills are suitable.

There are no special requirements to storage, but it is not recommended to store the material edgewise to avoid possible damages (broken corners, etc.)

INSTALLATION INSTRUCTIONS

SYSTEM COMPONENTS

1. shower base, edge h 30mm
2. dip-tube
3. o-rings 3 pcs
4. connect transfer
5. shims
6. drain body parts (depth under the shower base 100 mm)
7. plastic support
8. stainless support
9. stainless cover (filled with floor tile)

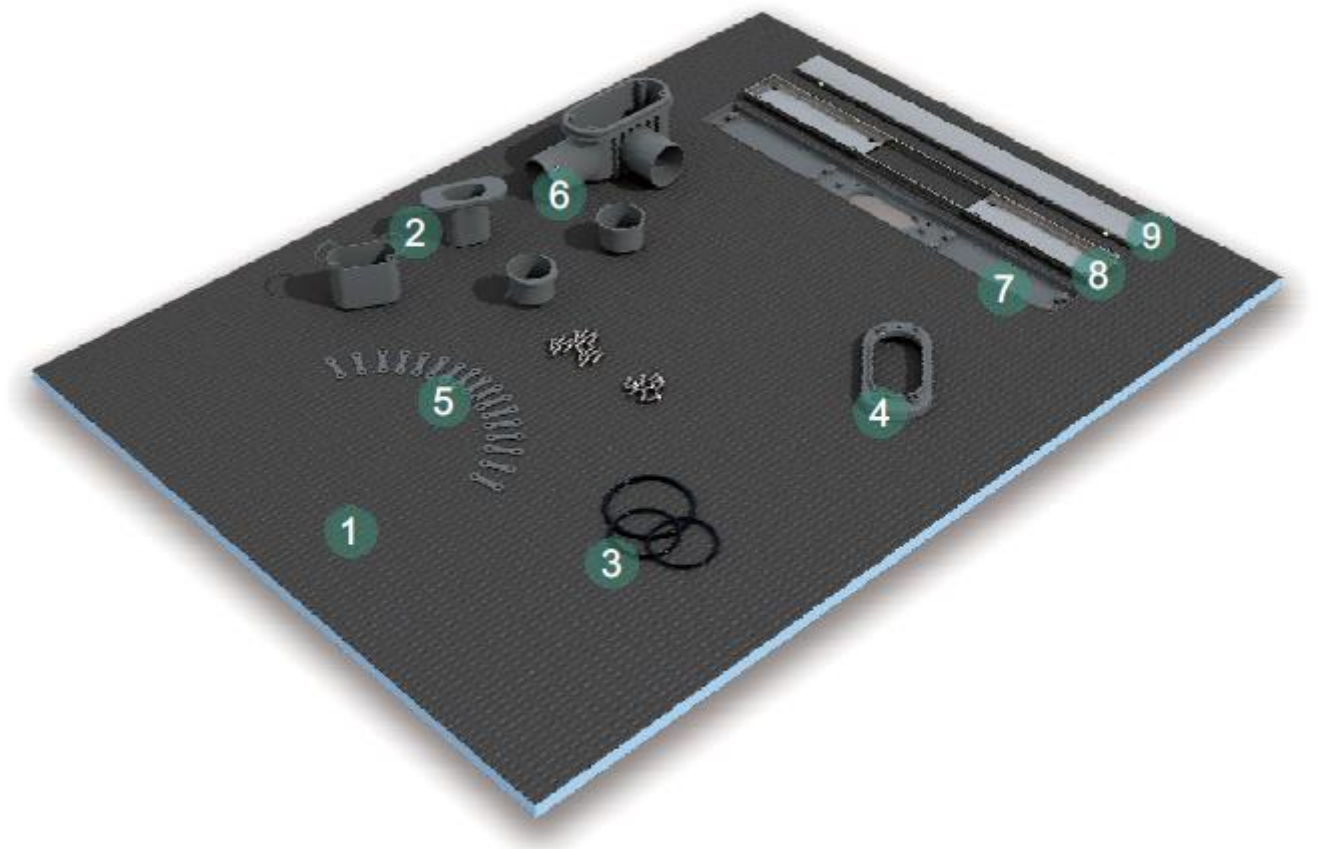
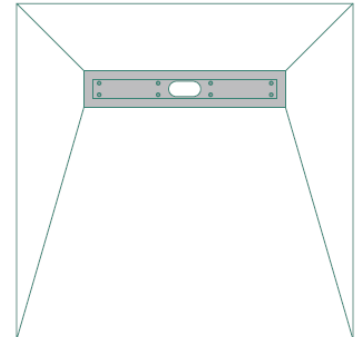

INSTALLATION INSTRUCTIONS

INSTALLATION FOR WOODEN FLOOR



1. Place the shower tray in designed position and mark a circle along the hole of drain body. Cut out a shape on the floor to install the shower tray.



2. Cutting drain shape out of plywood for waste, this should be 10 mm higher than drain body. Connecting the drain body to the waste pipe using connector. Coated with glue on drain body and connect with water pipe. Close the hole not using with Tycroc Premium Fix and plug. (Always check for leaks before final installation of shower tray).



3. After the leveling screed has hardened, an appropriate adhesive (e.g. tile adhesive/flexible glue) is applied all over the underside of the shower unit with a notched spatula.

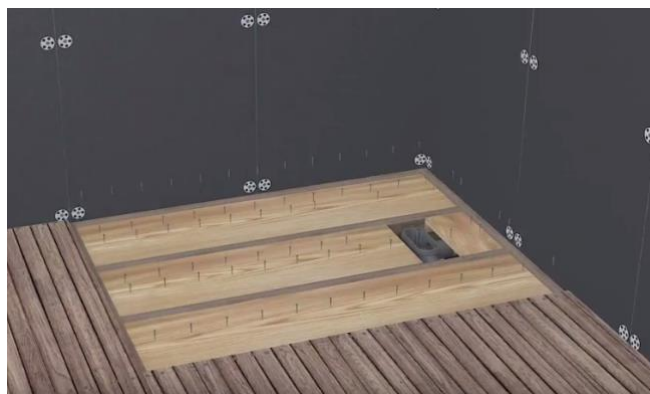

4. Make the wooden floor under the shower base.



5. Re-pave the board and reserve a hole for shower drain. Spread adhesive evenly over the floor with toothed scraper, place the shower tray onto the floor in correct position.



6. Install the O-ring on the reverse side of the shower tray, fix it with drain accessories and secure with screws.

INSTALLATION INSTRUCTIONS

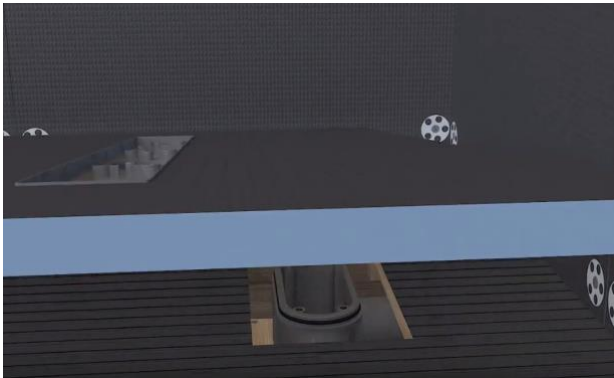

7. Install the O-ring on the shower drain body, put the shower base on the floor and connect it with drain body.



8. Install the plastic support and drain body, fix it with screws.

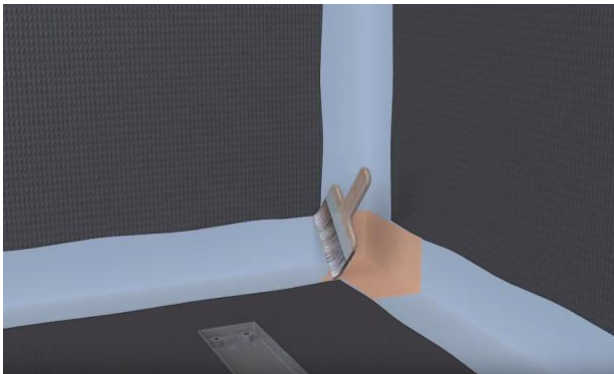

9. After installation is completed, level it with the gradienter (ensure the shower tray is horizontal). And then do some waterproofing treatments on the gap of boards with waterproof coating.

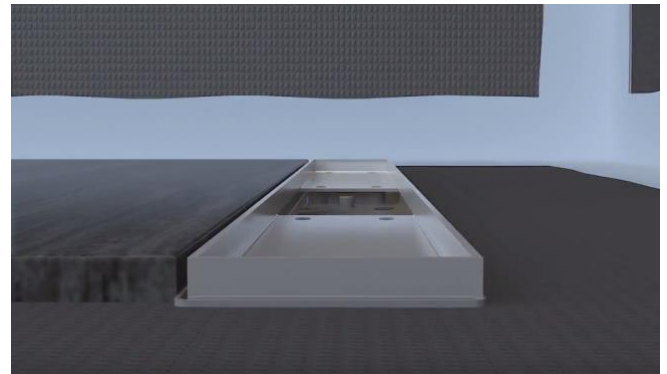

10. Install the stainless support, fix it with screws. After the waterproofing treatment is completed, do the tile paving.



11. Appropriate tile height $\leq 10\text{mm}$, If the tiles height $\geq 10\text{mm}$, please balance the height by riser piece which enclosed.

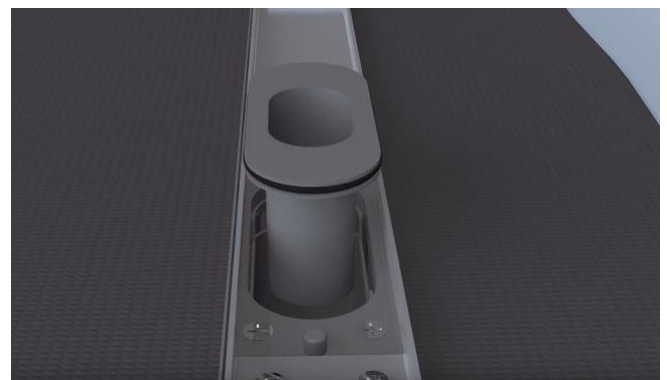

12. And then, install the other drain accessories on the drain body. The shower base is finished and can be tiled.

INSTALLATION INSTRUCTIONS

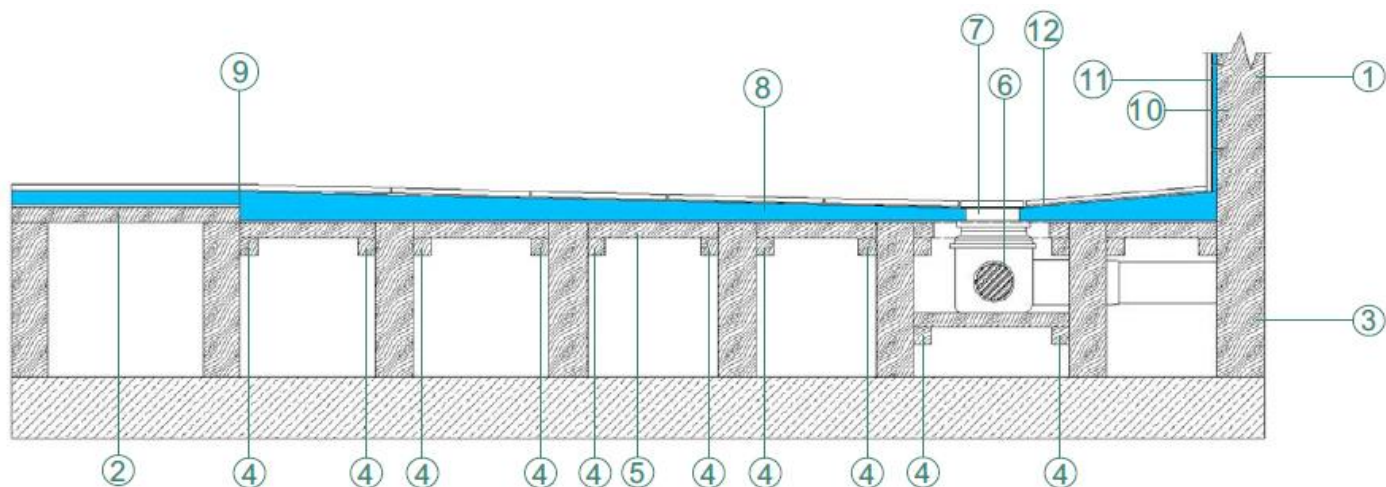

- | | |
|---|--|
| 1. Wooden wall construction | 8. Tycroc shower base |
| 2. $\geq 18\text{mm}$ plywood või OSB chipboard | 9. Sealing tape and waterproofing |
| 3. Floor joist (max 300mm distance) | 10. $\geq 12\text{mm}$ Tycroc TWP |
| 4. Support for plywood or OSB chipboard | 11. Metal washer and screw (covered by Tycroc Premium Fix) |
| 5. $\geq 18\text{mm}$ plywood või OSB chipboard | 12. Floor tile |
| 6. Floor drain body | |
| 7. Stainless support | |

NOTICE! The information in this leaflet is based on our experience and current materials specification. It represents no specific guarantee and the instructions for use outlined should be always observed together with considerations regarding building structure and existing building law.

INSTALLATION FOR CONCRETE FLOOR

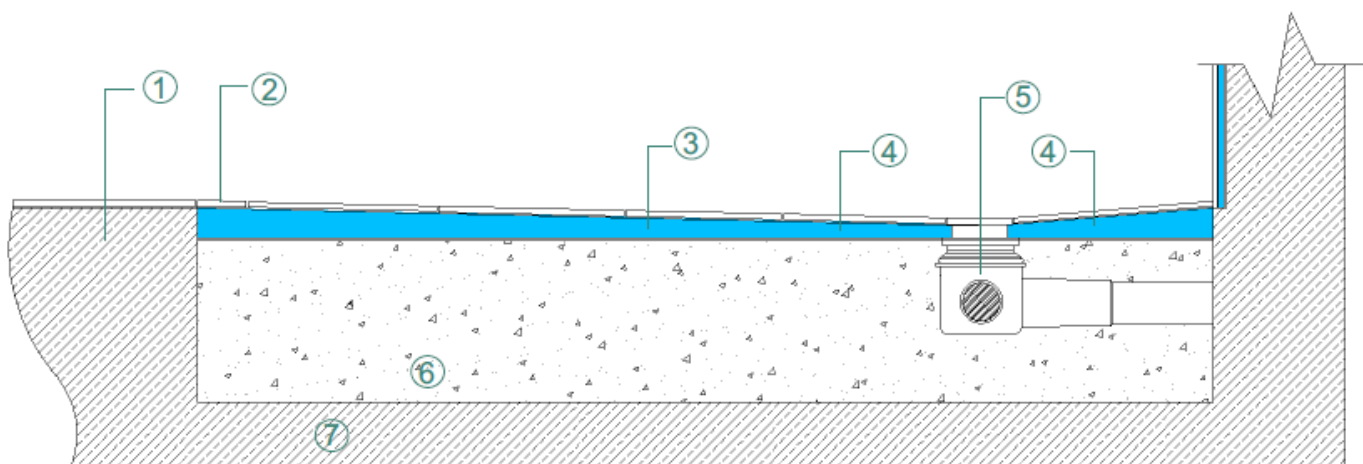

- | | |
|-----------------------------------|---------------------|
| 1. Screed | 5. Floor drain body |
| 2. Sealing tape and waterproofing | 6. Levelling screed |
| 3. Tycroc shower base | 7. Concrete floor |
| 4. Slope | |

INSTALLATION INSTRUCTIONS



NOTICE! The information in this leaflet is based on our experience and current materials specification. It represents no specific guarantee and the instructions for use outlined should be always observed together with considerations regarding building structure and existing building law.

